

WELCOME TO

PH204-1 Emerald Lane



**Shawn
Zigelstein**
Broker

TEAM **ZOLD**

Your Home • Your Life • Your Realtors

Working For You!

905.731.2000
www.teamzold.com



**Your
Community**
REALTY™



BROKERAGE INDEPENDENTLY OWNED & OPERATED

PH204-1 Emerald Lane, Vaughan

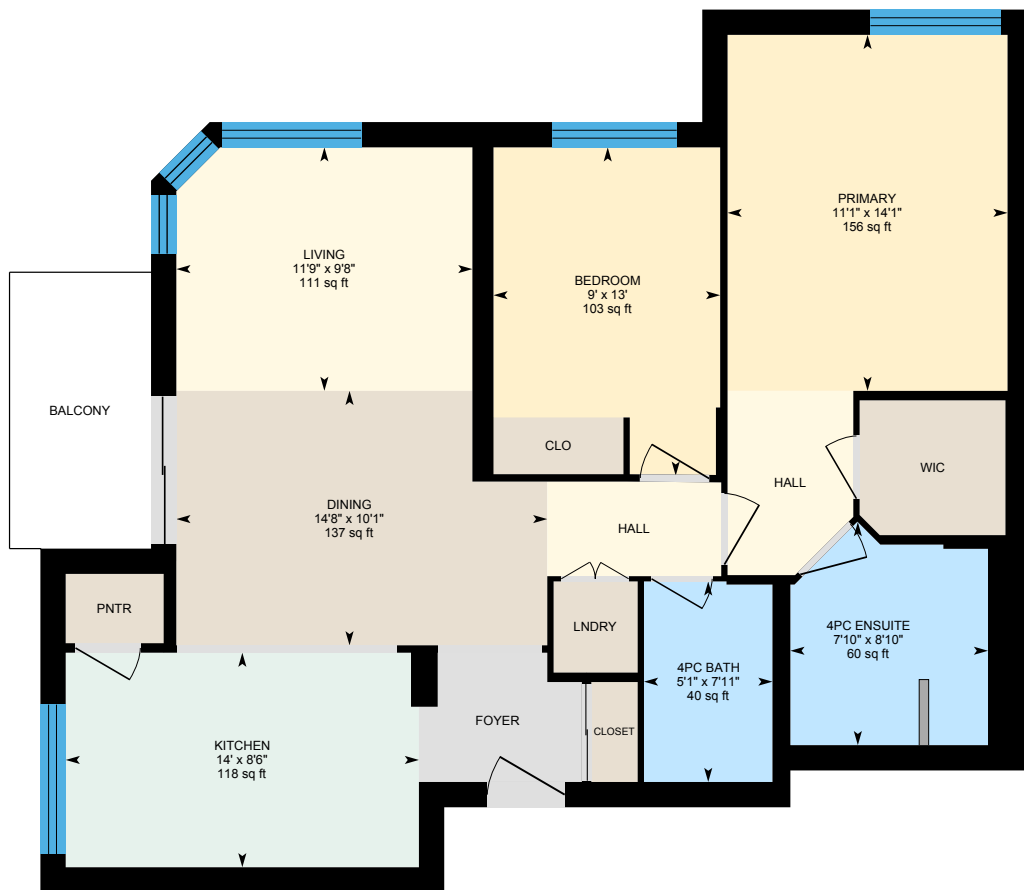



PUBLIC SCHOOLS

Your neighbourhood is part of a community of Public Schools offering Elementary, Middle, and High School programming.

Westminster PS

Designated Catchment School
Grades PK to 8
366 Mullen Dr

ÉÉ Paul-Demers

Designated Catchment School
Grades PK to 6
100 Ravel Rd

ÉS Norval-Morriseau

Designated Catchment School
Grades 7 to 12
51 Wright St

Louis-Honoré Fréchette PS

Designated Catchment School
Grades 1 to 8
40 New Westminster Dr

Thornhill SS

Designated Catchment School
Grades 9 to 12
167 Dudley Ave

Other Local Schools

Claude Watson School for the Arts
Grades 4 to 8
130 Doris Ave

ALTERNATIVE & SPECIAL SCHOOLS

Nearby alternative and special education schools include:

North West Secondary Alternative School

Grades 10 to 12
425 Patricia Ave

Drewry Secondary School

Grades 9 to 12
70 Drewry Ave



CATHOLIC SCHOOLS

Your neighbourhood is part of a community of Catholic Schools offering Elementary, Middle, and High School programming.

Blessed Scalabrini Catholic ES

Grades PK to 8
290 York Hill Blvd

ÉÉC Le-Petit-Prince

Grades PK to 6
79 Avro Rd

St Elizabeth Catholic HS

Grades 9 to 12
525 New Westminster Dr

ÉSC Renaissance

Grades 7 to 12
700 Bloomington Rd

PRIVATE SCHOOLS

The private schools nearest to you are:



Alborz School

Grades 9 to 12
20 Tangreen Court

Joe Dwek Ohr HaEmet Sephardic School

Grades PK to 8
7026 Bathurst St

JNY Day School

Grades 1 to 7
465 Patricia Ave

The Toronto Cheder

Grades K to 8
475 Patricia Avenue



PARKS & REC.

This home is located in park heaven, with 4 parks and a long list of recreation facilities within a 20 minute walk from this address.

Moore Park
110 Cactus Ave

5 mins

Vaughan Crest Park
300 Pinewood Dr

9 mins

Lakehurst Park
486 Conley Street

7 mins

FACILITIES WITHIN A 20 MINUTE WALK

4 Playgrounds 5 Sports Fields
6 Tennis Courts 1 Sports Court
1 Basketball Court 2 Outdoor Games
2 Ball Diamonds Facilities



TRANSIT

Public transit is at this home's doorstep for easy travel around the city. The nearest street transit stop is only a minute walk away and the nearest rail transit stop is a 33 minute walk away.

Nearest Rail Transit Stop
Finch Station

Nearest Street Level Transit Stop
Steeles Av / Emerald Lane

1 min

SAFETY

With safety facilities in the area, help is always close by. Facilities near this home include a fire station, a police station, and a hospital within 6.67km.

North York General Hospital
4001 Leslie St

Fire Station
835 Clark Ave W

Police Station
30 Eglerslie Ave



HoodQ

Disclaimer: These materials have been prepared for shawn@eaznold.com and are not intended to solicit buyers or sellers currently under contract with a brokerage. By accessing this information you have agreed to our terms of service, which are hereby incorporated by reference. This information may contain errors and omissions. You are not permitted to rely on the contents of this information and must take steps to independently verify its contents with the appropriate authorities (school boards, governments etc.). As a recipient of this information, you agree not to hold us, our licensors or the owners of the information liable for any damages, howsoever caused.

Welcome Home To This Amazing Lower Penthouse Suite In The Eiffel Tower Condos By Menkes

This Bright South East Facing Unit Is A Spectacular Place To Watch The Sunrise With Treed And City Views From All Rooms. If You Are Looking For Executive Living With A Beautifully Renovated Condo, Then This Is The Place For You. Open Concept Kitchen With Granite Counter Tops And High End Finishes, Hardwood Floors, Spa Like Ensuite, Open Balcony, 2 Great Sized Bedrooms, And So Much More. The Amenities In The Building Are Unlike Anything Else In The Area, Party Room, Gym, Outdoor Pool, Security On Site With Staffed Gatehouse, And This Building Is Close To TTC, Restaurants, Shops, Parks, And Anything Else You Could Imagine. Book Your Private Showing To See Your New Condo Today.

Extras: All Existing Stainless Steel Appliances: Kenmore Elite French Door Fridge, Kenmore Built-In Microwave, Kenmore Flat Top Slide-In Stove, Kenmore Built-In Dishwasher; Whirlpool Duet Stackable Washer and Dryer, All Window Coverings, All Electrical Light Fixtures, Furnace, Parking, Locker

Taxes: \$2,613.55/2023 | Maintenance Fees: \$956.74/month

Royal LePage Your Community Realty Brokerage does not warrant or guarantee the information in this feature sheet.