

WELCOME TO

*189 Elm Street*

[www.189ElmStreet.com](http://www.189ElmStreet.com)



**Sarah Norris**  
Sales Representative



TEAM **ZOLD**

Your Home • Your Life • Your Realtors

*Working For You!*

905.731.2000  
[www.teamzold.com](http://www.teamzold.com)



ROYAL LEPAGE  
**CHAIRMAN'S CLUB**  
NATIONAL  
TOP 1%  
LIFETIME MEMBER



**Shawn Zigelstein**  
Broker

# 189 Elm Street, Beaverton

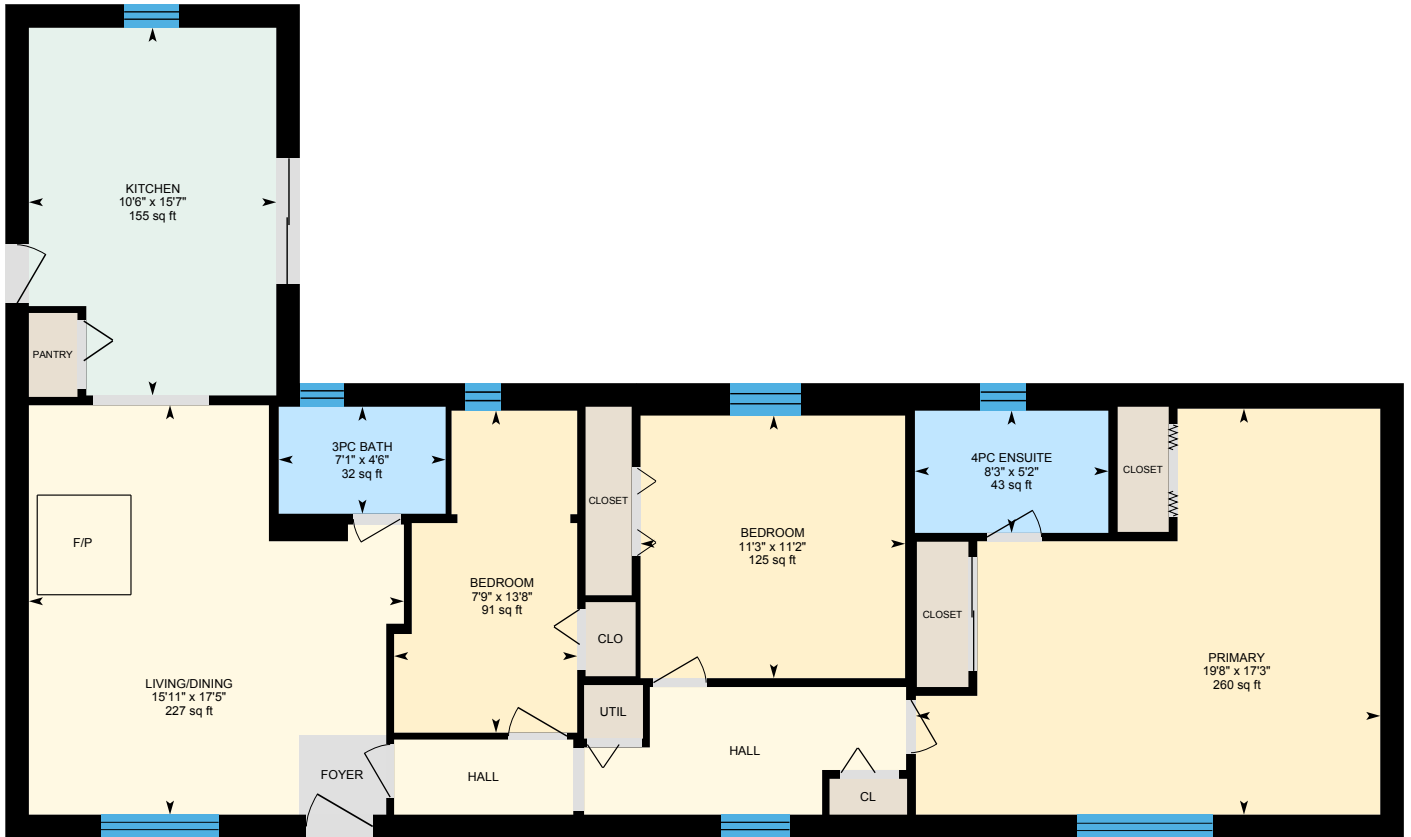



## PUBLIC SCHOOLS

Your neighbourhood is part of a community of Public Schools offering Elementary, Middle, and High School programming.

### Beaverton PS

Designated Catchment School  
Grades PK to 8  
270 King St

### Brock HS

Designated Catchment School  
Grades 9 to 12  
12 Concession Rd 13

## CATHOLIC SCHOOLS

Your neighbourhood is part of a community of Catholic Schools offering Elementary, Middle, and High School programming.

### Holy Family Catholic School

Grades PK to 8  
720 Simcoe St

### ÉÉC Samuel-de-Champlain

Grades PK to 6  
275 Park St

### ÉSC Nouvelle-Alliance

Grades 7 to 12  
249 Anne St N

### St. Mary Catholic Secondary School

Grades 9 to 12  
1918 Whites Rd

## PARKS & REC.

Fun is easy to find at the parks near this home. There are lots of opportunities for sports, relaxation and play in nearby parks and recreation facilities.

### Beaverton King Street Park

270 King St



2 mins

### Beaverton Harbour Park / Beaverton-Thoran Community Centre

24 Harbour Park Crescent



8 mins

### Mill Gateway Park

284 Simcoe St



4 mins

### FACILITIES WITHIN A 20 MINUTE WALK

- |                    |                               |
|--------------------|-------------------------------|
| 4 Playgrounds      | 1 Skateboard Park             |
| 2 Rinks            | 1 Golf Course                 |
| 1 Tennis Court     | 1 Beach                       |
| 1 Volleyball Court | 1 Sports Court                |
| 1 Basketball Court | 1 Boating Facility            |
| 3 Ball Diamonds    | 1 Fairground                  |
| 1 Sports Field     | 1 Fishing Location            |
| 1 Track            | 1 Trail                       |
| 1 Community Centre | 2 Arts/Performance Facilities |
| 1 Splash Pad       |                               |



## TRANSIT

Public transit is at this home's doorstep for easy travel around the city. The nearest street transit stop is only a 6 minute walk away.

### Nearest Street Level Transit Stop

Simcoe St. @ Mara Rd.



6 mins

## SAFETY

With safety facilities in the area, help is always close by. Facilities near this home include a fire station, a police station, and a hospital within 28.42km.

### Orillia Soldiers' Memorial Hospital

170 Colborne St W

### Fire Station

360 Bay Street

### Police Station

412 Bay St



# HoodQ

Disclaimer: These materials have been prepared for shawn@teamzold.com and are not intended to solicit buyers or sellers currently under contract with a brokerage. By accessing this information you have agreed to our terms of service, which are hereby incorporated by reference. This information may contain errors and omissions. You are not permitted to rely on the contents of this information and must take steps to independently verify its contents with the appropriate authorities (school boards, governments etc.). As a recipient of this information, you agree not to hold us, our licensors or the owners of the information liable for any damages, howsoever caused.

## LOCATION! LOCATION! LOCATION!

This 80'x100' Property Is Situated On A Lovely Tree-Lined Street Just Minutes To The Beach, Splash Park, Boat Launch & Downtown Beaverton Where Quaint Coffee Shops, Restaurants, Shops And So Much More, Awaits You. And Bonus - It's Just Steps Away From The New Elem. School, Beaver River Public, Scheduled to Open In Sept '24. This Advanced Facility Will House 400 Children, Plus Day Care & A Family Center. Perfect for this Growing Community.

189 Elm Features A Great Layout, with 3 Bedrooms (Primary Is Huge @ 17'3x19'8) & Two Full Bathrooms. The Eat-In Kitchen Opens Onto The Deck & Yard Where Children Can Kick Around A Ball, Or You Can Host A Party With Family & Friends. This Bungalow Is Perfect For A Growing Family, Retirees, Or Anyone Who Is Looking For An Affordable Home. With Some Needed TLC, This Home And Large Property Is The Perfect Investment & Your Chance To Create Your Dream Home...

And Hey, There's Just Nothing Better Than A Lake Simcoe Sunset!  
Close To Orillia And Less Than An Hour To Many Surrounding Cities (Barrie, Newmarket, Lindsay, Peterborough, Uxbridge, Stouffville and Markham), & Easy Access To Toronto.

Extras: All Existing: Appliances, Electrical Light Fixtures & Ceiling Fans, Window Coverings, Wood Stove, Security System, HWT, Bathroom Mirrors, Garden Shed.

Lot: 80.57 ft. x 100.2 ft. | Taxes \$1,972.37/ 2023

Royal LePage Your Community Realty Brokerage does not warrant or guarantee the information in this feature sheet.